

# SCM Series

## SMD Common Mode Inductor

### Size 1211

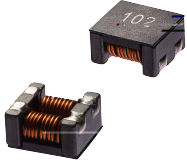

#### FEATURES

- Chip common mode filter for large current applications.
- Low profile design makes it optimal for surface mounting.
- Operating temperature -40~+125 °C
- Quantity:500 pcs

#### APPLICATIONS

- Power line noise countermeasure for various electronic equipment
- Noise countermeasure for adapter lines and battery lines or larger electronic equipment such as note PCs and word processors

#### Dimensions: [mm]

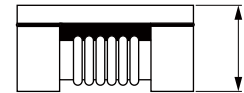
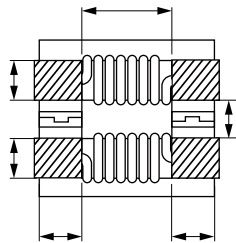
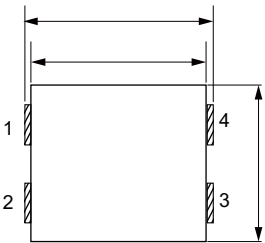

#### Schematic:

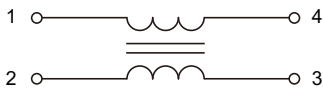

#### Land Pattern:[mm]

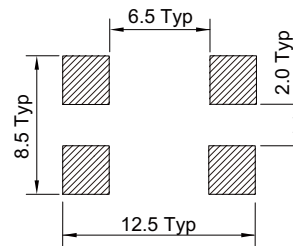

#### Electrical Properties:

Part No	Impedance @ 100 MHz Min. (Ω)	Impedance @ 100 MHz Typ. (Ω)	DC Resistance Max. (mΩ)	Temperature Rise Current Max. (A)	Rated Volt Max. (V)	IR Min. (MΩ)

Part No	Impedance @ 100 MHz Min. ( $\Omega$ )	Impedance @ 100 MHz Typ. ( $\Omega$ )	DC Resistance Max. (m $\Omega$ )	Temperature Rise Current Max. (A)	Rated Volt Max. (V)	IR Min. (M $\Omega$ )

### Typical Electrical Characteristics:

