

# FHC Series

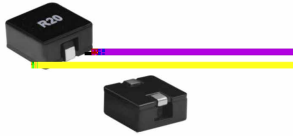

## CHARACTERISTICS

- Low Rdc with flat wire design
- Low copper losses at high frequency
- Magnetic shielded structure
- Quantity: 800pcs

## APPLICATION

- High current DC/DC converter
- LC filter

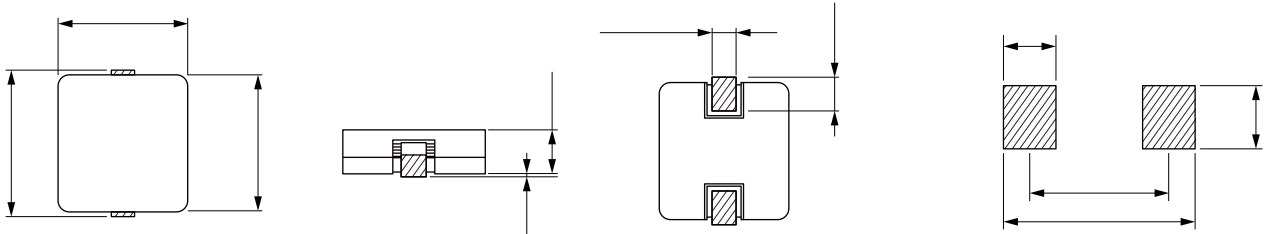

	( $\mu$ H)		(A)	Saturation (A)	(m $\Omega$ )	(m $\Omega$ )
FHC1030-R20M	0.20	$\pm 20\%$	22.0	50.0	0.82	0.98
FHC1030-R33M	0.33	$\pm 20\%$	18.0	36.0	2.17	2.50
FHC1030-R56M	0.56	$\pm 20\%$	18.0	30.0	2.17	2.50
FHC1030-R68M	0.68	$\pm 20\%$	14.0	23.0	4.79	5.40
FHC1030-1R0M	1.00	$\pm 20\%$	14.0	21.0	4.79	5.40
FHC1030-1R2M	1.20	$\pm 20\%$	12.0	20.0	6.60	7.40
FHC1030-1R5M	1.50	$\pm 20\%$	12.0	18.0	6.60	7.40
FHC1030-2R2M	2.20	$\pm 20\%$	9.00	15.0	11.4	12.5

Operating Temperature:  $-40^{\circ}\text{C}$  to  $+125^{\circ}\text{C}$

Temperature Rise Current: the actual value of DC current when the temperature rise is  $150^{\circ}\text{C}$

Saturation Current that will cause initial inductance to drop approximately 30%

