

# CMC Series

## Common Mode Choke

### Size 2517

#### CHARACTERISTICS

两组相同圈数的线圈绕制在同一磁体上，实现共模噪声的抑制  
采用紧凑均匀的绕线工艺，有效减低寄生电容，提高线间耐压等级  
标称额定电压250Vac; 线间绝缘测试电压1500Vac  
工作温度范围：-55 ~+125

#### APPLICATION

电源线输入、输出共模噪声消减和浪涌抑制（250Vac）  
电力电源装置的浪涌抑制和EMI滤波  
浮地装置的滤波  
EMI对策用  
特别适用于AC/DC转换，DC/AC逆变等线路的电磁干扰抑制

#### Dimensions: [mm]

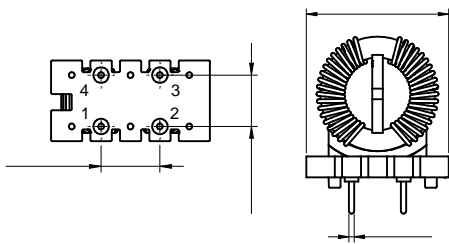

#### Land Pattern: [mm]

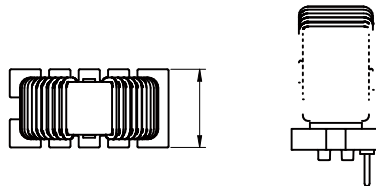

#### Schematic:

## Electrical Properties:

Part No.		$I_R$		Vac	Vac	Core Material	Test Condition
CMC2517-102N	1,000	6.0	13	1500	250		
CMC2517-222N	2,200	4.0	30	1500	250		
CMC2517-332N	3,300	2.5	60	1500	250		
CMC2517-502N	5,000	2.5	95	1500	250		
CMC2517-103N	10,000	2.0	125	1500	250		
CMC2517-203N	20,000	1.5	270	1500	250		

## Typical Electrical Characteristics:

### Insertion Loss Common Mode

